

SINGLE ROW RADIAL LIGHT BEARINGS

6800 SERIES

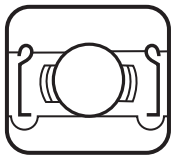

ZZ

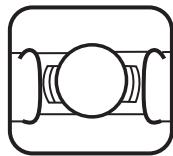

2RS

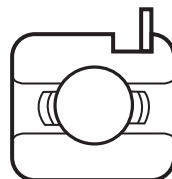

NR

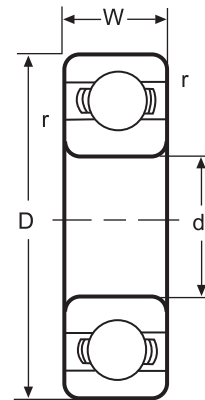

OPEN

Bearing No.	Bore d		Outer Diameter D		Width W		Radius r		Basic Load Rating lbs.		Weight	
	mm	in.	mm	in.	mm	in.	mm	in.	Dynamic C	Static C ₀	kg	lbs.
6800	10	0.3937	19	0.7480	5	0.1969		0.019	410	208	0.005	0.0115
6801	12	0.4724	21	0.8268	5	0.1969	0.5	0.019	430	234	0.006	0.013
6802	15	0.5906	24	0.9449	5	0.1969	0.5	0.019	465	283	0.007	0.015
6803	17	0.6693	26	1.0236	5	0.1969	0.5	0.019	630	385	0.008	0.018
6804	20	0.7874	32	1.2598	7	0.2756	0.5	0.019	900	555	0.019	0.042
6805	25	0.9843	37	1.4567	7	0.2756	0.5	0.019	965	665	0.022	0.053
6806	30	1.1811	42	1.6535	7	0.2756	0.5	0.019	1060	815	0.026	0.055
6807	35	1.3780	47	1.8504	7	0.2756	0.5	0.019	1100	905	0.029	0.063
6808	40	1.5748	52	2.0472	7	0.2756	0.5	0.019	1140	985	0.033	0.072
6809	45	1.7717	58	2.2835	7	0.2756	0.5	0.019	1419	1270	0.040	0.088
6810	50	1.9685	65	2.5591	7	0.2756	0.5	0.019	1480	1370	0.052	0.114
6811	55	2.1654	72	2.8346	9	0.3543	0.5	0.019	1980	1820	0.083	0.182
6812	60	2.3622	78	3.0709	10	0.3937	0.5	0.019	2580	2380	0.106	0.233
6813	65	2.5591	85	3.3465	10	0.3937	1	0.039	2610	2480	0.128	0.281
6814	70	2.7559	90	3.5433	10	0.3937	1	0.039	2720	2680	0.137	0.301
6815	75	2.9528	95	3.7402	10	0.3937	1	0.039	2820	2890	0.145	0.319
6816	80	3.1496	100	3.9370	10	0.3937	1	0.039	2850	2990	0.154	0.338
6817	85	3.3465	110	4.3307	13	0.5118	1.5	0.059	4200	4250	0.270	0.594
6818	90	3.5433	115	4.5276	13	0.5118	1.5	0.059	4250	4450	0.285	0.627
6819	95	3.7402	120	4.7244	13	0.5118	1.5	0.059	7400	7100	0.300	0.660
6820	100	3.9370	125	4.9213	13	0.5118	1.5	0.059	4400	4750	0.313	0.668
6821	105	4.1339	130	5.1181	13	0.5118	1.5	0.059	4450	4950	0.330	0.726
6822	110	4.3307	140	5.5118	16	0.6299	1.5	0.059	6450	7200	0.515	1.133
6824	120	4.7244	150	5.9055	16	0.6299	1.5	0.059	6500	7400	0.555	1.760
6826	130	5.1181	165	6.4961	18	0.7087	2	0.078	8300	9250	0.800	1.760

Larger sizes or New size available upon request