

# 4-BOLT FLANGE UNITS

## SET SCREW TYPE

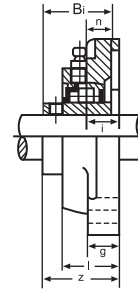
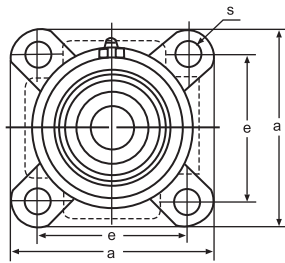

### UCF200-SERIES

Shaft Dia.		Unit No.	Dimensions(in.)									Bolt Used in.	Bearing No.	Housing No.	Weight	
mm	in.		a	e	i	g	l	s	z	Bi	n				kg	lbs.
12	1/2	UCF201-8	3-3/8	2-33/64	19/32	15/32	1	15/32	1-5/16	1.2205	0.5000	3/8	UC201-8	F204	0.65	1.43
	5/8	202-10											UC201-10			
	3/4	204-12											UC201-12			
		UCF201											UC201			
		202											UC201			
15		203	UC201													
17		204	UC201													
20			UC201													
25	7/8	UCF205-14	3-3/4	2-3/4	5/8	9/16	1-1/16	15/32	1-13/32	1.3386	0.5630	3/8	UC205-14	F205	0.85	1.87
	15/16	205-15											UC205-15			
	1	205-16											UC205-16			
		UCF205											UC205			
30	1-1/16	UCF206-17	4-1/4	3-17/64	45/64	9/16	1-7/32	15/32	1-19/32	1.5000	0.6260	3/8	UC206-17	F206	1.15	2.54
	1-1/8	206-18											UC206-18			
	1-3/16	206-19											UC206-19			
		206-20											UC206-20			
	1-1/4	UCF206											UC206			
35	1-1/4	UCF207-20	4-19/32	3-5/8	3/4	5/8	1-11/32	35/64	1-3/4	1.6890	0.6890	7/16	UC207-20	F207	1.60	3.53
	1-5/16	207-21											UC207-21			
	1-3/8	207-22											UC207-22			
		207-23											UC207-23			
	1-7/16	UCF207											UC207			
40	1-1/2	UCF208-24	5-1/8	4-1/64	53/64	5/8	1-13/32	5/8	2-1/64	1.9370	0.7480	1/2	UC208-24	F208	2.05	4.52
	1-9/16	208-25											UC208-25			
		UCF208											UC208			
45	1-5/8	UCF209-26	5-13/32	4-9/64	55/64	23/32	1-1/2	5/8	2-1/16	1.9370	0.7480	1/2	UC209-26	F209	2.38	5.25
	1-11/16	209-27											UC209-27			
	1-3/4	209-28											UC209-28			
		UCF209											UC209			
50	1-7/8	UCF210-30	5-5/8	4-3/8	55/64	23/32	1-9/16	5/8	2-5/32	2.0315	0.7480	1/2	UC210-30	F210	2.50	5.51
	1-15/16	210-31											UC210-31			
		UCF210											UC210			
55	2	UCF211-32	6-3/8	5-1/8	63/64	25/32	1-11/16	3/4	2-5/16	2.1890	0.8740	5/8	UC211-32	F211	3.60	7.94
	2-1/8	211-34											UC211-34			
	2-3/16	211-35											UC211-35			
		UCF211											UC211			
60	2-1/4	UCF212-36	6-7/8	5-5/8	1-9/16	25/32	1-7/8	3/4	2-23/32	2.5630	1.0000	5/8	UC212-36	F212	4.90	10.8
	2-3/8	212-38											UC212-38			
	2-7/16	212-39											UC212-39			
		UCF212											UC212			
65	2-1/2	UCF213-40	7-3/8	5-55/64	1-3/16	25/32	1-31/32	3/4	2-3/4	2.5630	1.0000	5/8	UC213-40	F213	5.90	13.0
		UCF213											UC213			
70	2-3/4	UCF214-44	7-19/32	5-63/64	1-7/32	15/64	2-1/8	3/4	2-31/32	2.9370	1.1890	5/8	UC214-44	F214	6.30	13.9
		UCF214											UC214			
75	2-15/16	UCF215-47	7-7/8	6-17/64	1-11/32	15/16	2-7/32	3/4	3-3/32	3.0630	1.3110	5/8	UC215-47	F215	6.80	15.0
		215-48											UC215-48			
	3	UCF215											UC215			